

LONG STRAW RANCH

Upland Bird Hunting in Forestburg, Texas

Driving Directions from Dallas, Texas

- Take I-35E North from downtown Dallas area (merging onto I-35 at Denton) to Sanger
- Take I-35 Exit 478 ("FM-455/Pilot Point/Bolivar") to FM-455 (West Chapman Drive); at the stoplight, take a LEFT onto WESTBOUND FM-455
- Proceed WEST on FM-455 to Forestburg, Texas (approximately 29 miles)
- Entering Forestburg, keep LEFT and continue on WESTBOUND FM-455
- In 5-1/2 miles, you come to Netherly Road (which is RIGHT turn only)
- Turn RIGHT onto Netherly Road and continue NORTHEAST on Netherly approximately one mile

Long Straw Ranch's main entrance is on your RIGHT at a double green pipe gate (2197 Netherly Road, Forestburg, Texas 76239)

Driving Directions from Fort Worth, Texas

- Take I-35W North from downtown Fort Worth area (merging onto I-35 at Denton) to Sanger
- Take I-35 Exit 478 ("FM-455/Pilot Point/Bolivar") to FM-455 (West Chapman Drive); at the stoplight, take a LEFT onto WESTBOUND FM-455
- Proceed WEST on FM-455 to Forestburg, Texas (approximately 29 miles)
- Entering Forestburg, keep LEFT and continue on WESTBOUND FM-455
- In 5-1/2 miles, you come to Netherly Road (which is RIGHT turn only)
- Turn RIGHT onto Netherly Road and continue NORTHEAST on Netherly approximately one mile

Long Straw Ranch's main entrance is on your RIGHT at a double green pipe gate (2197 Netherly Road, Forestburg, Texas 76239)

LONG STRAW RANCH

Upland Bird Hunting in Forestburg, Texas

Driving Directions from Houston, Texas

- Take I-45 North from downtown Houston area into Dallas, using Exit 284A to merge onto Westbound I-30
- Take I-30 West, following signs for I-35E N, and merge onto Northbound I-35E
- Take I-35E North from downtown Dallas (merging onto I-35 at Denton) to Sanger
- Take I-35 Exit 478 ("FM-455/Pilot Point/Bolivar") to FM-455 (West Chapman Drive); at the stoplight, take a LEFT onto WESTBOUND FM-455
- Proceed WEST on FM-455 to Forestburg, Texas (approximately 29 miles)
- Entering Forestburg, keep LEFT and continue on WESTBOUND FM-455
- In 5-1/2 miles, you come to Netherly Road (which is RIGHT turn only)
- Turn RIGHT onto Netherly Road and continue NORTHEAST on Netherly approximately one mile

Long Straw Ranch's main entrance is on your RIGHT at a double green pipe gate (2197 Netherly Road, Forestburg, Texas 76239)

Driving Directions from Oklahoma City, Oklahoma

- Take I-40 East from downtown Oklahoma area and follow signs to I-35S Dallas
- Take I-40 Exit 151B to Southbound I-35 (via I-235 South)
- Continue South on I-35 to Gainesville, Texas
- Take I-35 Exit 497 and proceed South on FM-51 S / West California Street (toward FM-1630 W / FM-455 W)
- South of Gainesville, turn RIGHT onto Westbound FM-1630 / Westbound FM-455 toward Forestburg
- Proceed WEST on FM-455 to Forestburg, Texas (approximately 29 miles)
- Entering Forestburg, keep LEFT and continue on WESTBOUND FM-455
- In 5-1/2 miles, you come to Netherly Road (which is RIGHT turn only)
- Turn RIGHT onto Netherly Road and continue NORTHEAST on Netherly approximately one mile

Long Straw Ranch's main entrance is on your RIGHT at a double green pipe gate (2197 Netherly Road, Forestburg, Texas 76239)

LONG STRAW RANCH

Upland Bird Hunting in Forestburg, Texas

Driving Directions from Tulsa, Oklahoma

- Take I-244 West from downtown Tulsa area toward Westbound I-44
- Continue South and West on I-44 to Oklahoma City
- Approaching Oklahoma City on Westbound I-44, use the left lane to merge onto Southbound I-35 (Oklahoma City / Downtown / Kilpatrick Turnpike)
- Continue South on I-35 out of Oklahoma City, through Ardmore, and into Texas
- Continue South on I-35 to Gainesville, Texas
- Take I-35 Exit 497 and proceed South on FM-51 S / West California Street (toward FM-1630 W / FM-455 W)
- South of Gainesville, turn RIGHT onto Westbound FM-1630 / Westbound FM-455 toward Forestburg
- Proceed WEST on FM-455 to Forestburg, Texas (approximately 29 miles)
- Entering Forestburg, keep LEFT and continue on WESTBOUND FM-455
- In 5-1/2 miles, you come to Netherly Road (which is RIGHT turn only)
- Turn RIGHT onto Netherly Road and continue NORTHEAST on Netherly approximately one mile

Long Straw Ranch's main entrance is on your RIGHT at a double green pipe gate (2197 Netherly Road, Forestburg, Texas 76239)

Driving Directions from Shreveport, Louisiana

- Take I-20 West from downtown Shreveport area toward Texas
- Approaching Dallas, follow signs to TX-557 and US-80, keeping RIGHT at the fork to merge onto Westbound US-80
- Continue West on US-80 toward I-635, then take the exit onto Northbound I-635
- Continue North and West on I-635, around Dallas, then use the RIGHT THREE LANES to take Exit 27A onto Northbound I-35E toward Denton, Texas
- Continue Northbound on I-35E away from Dallas (merging onto Northbound I-35 at Denton) toward Sanger
- Take I-35 Exit 478 ("FM-455/Pilot Point/Bolivar") to FM-455 (West Chapman Drive); at the stoplight, take a LEFT onto WESTBOUND FM-455
- Proceed WEST on FM-455 to Forestburg, Texas (approximately 29 miles)
- Entering Forestburg, keep LEFT and continue on WESTBOUND FM-455
- In 5-1/2 miles, you come to Netherly Road (which is RIGHT turn only)
- Turn RIGHT onto Netherly Road and continue NORTHEAST on Netherly approximately one mile

Long Straw Ranch's main entrance is on your RIGHT at a double green pipe gate (2197 Netherly Road, Forestburg, Texas 76239)

LONG STRAW RANCH

Upland Bird Hunting in Forestburg, Texas

Maps

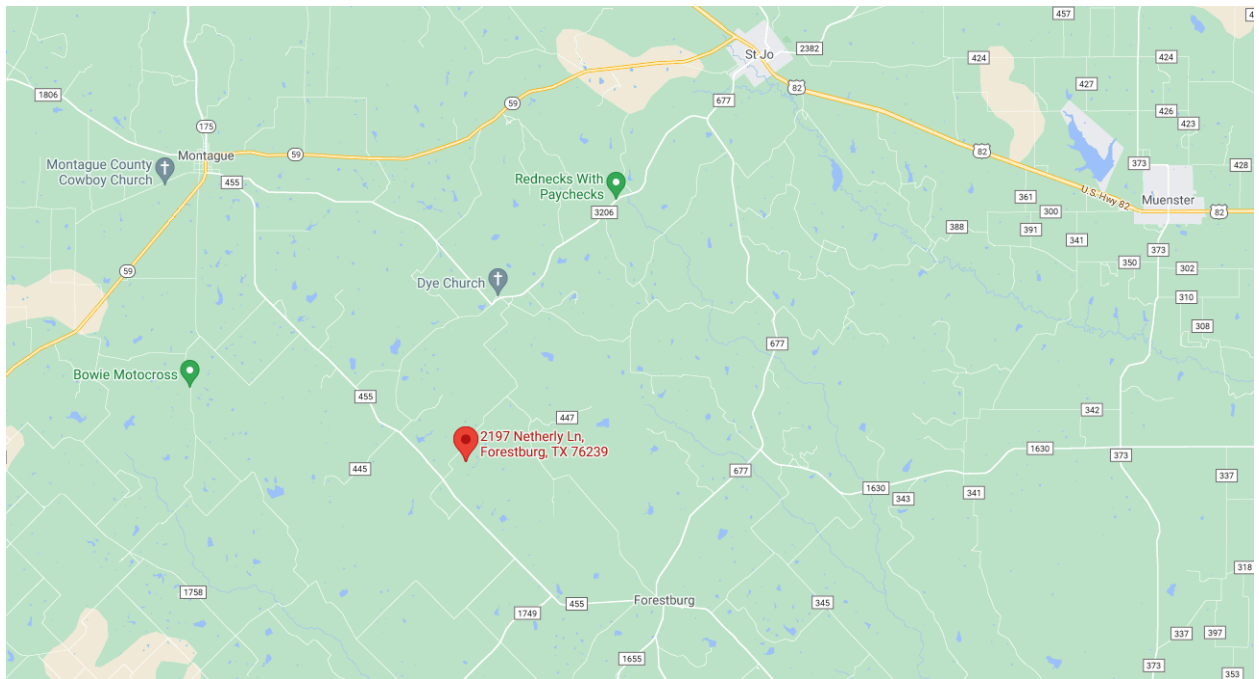
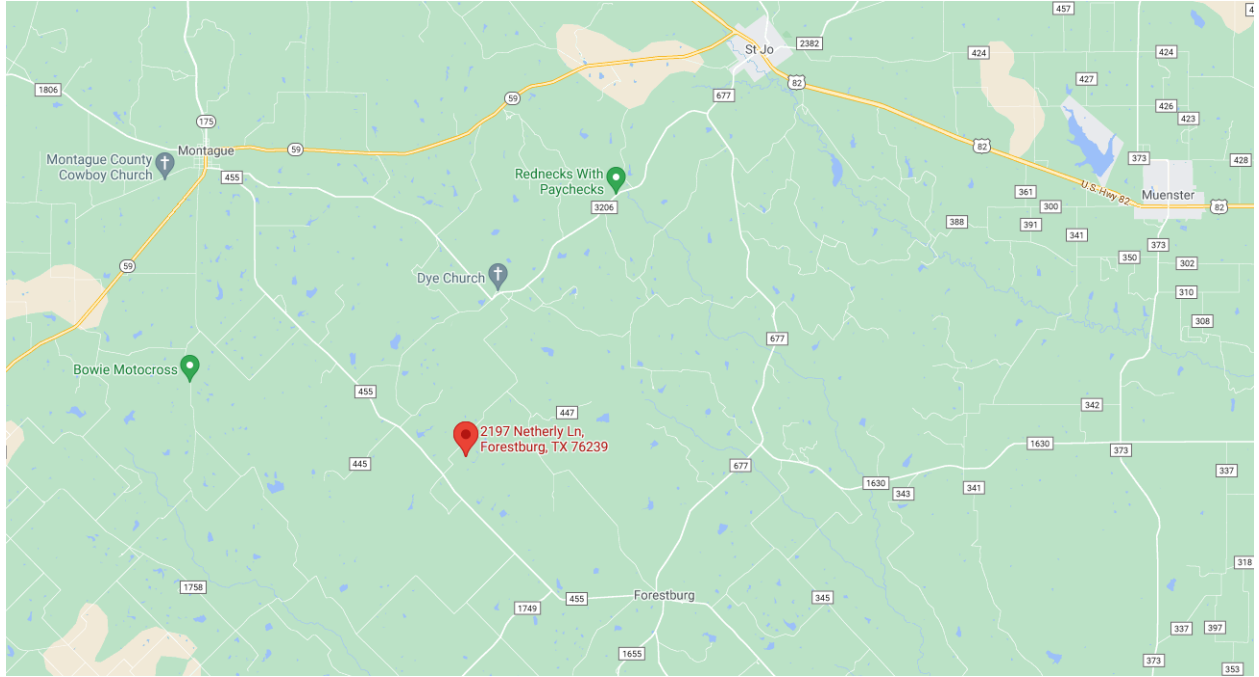

LONG STRAW RANCH

Upland Bird Hunting in Forestburg, Texas

Maps

